

# **CR-20 CUP HOLDER**

Thank you for purchasing the Crescendo CR-20 Cup Holder. You will find that this unique high quality cup makes having your drink within reach while performing or practicing very convenient.

The CR-20 is simple to attach and use. Please refer to the drawing while reading the instructions below.

Figure 1.

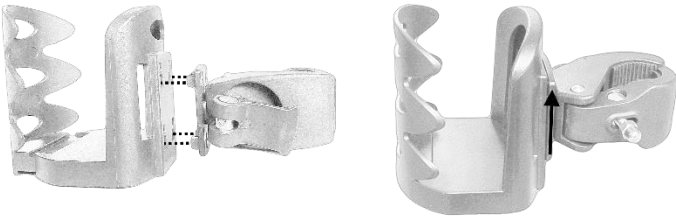

1. Take the clamp and cup holder out of the packaging. Attach clamp to cup holder by aligning the 4 tabs on the clamp to the 4 holes on the cup holder. After aligning the pieces, push up on the clamp to lock it into place.

Figure 2.

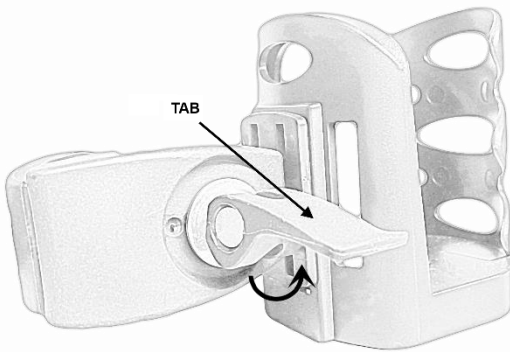

2. Pull up tab straight out.

Figure 3.

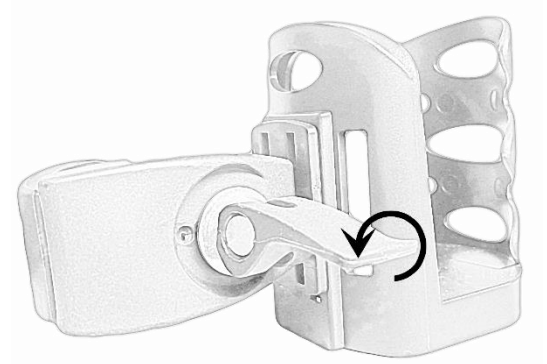

3. While holding the tab straight out, turn the tab counter-clockwise to loosen the clamp. If turned too much it may start tightening the clamp again.

Figure 4.

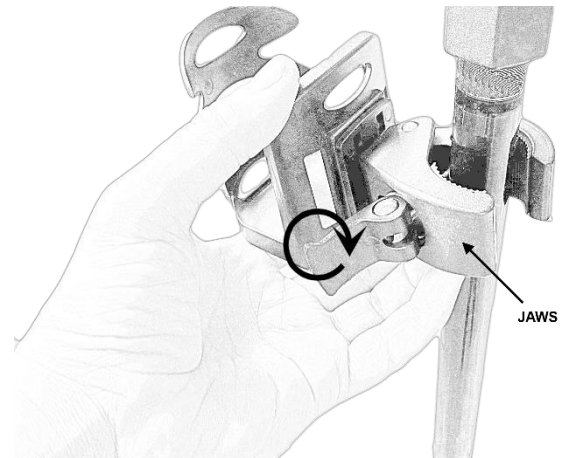

4. Pull apart the jaws of the clamp and place the clamp on a mic stand or music stand. While holding in place, turn the tab clockwise until there is a slight resistance as the jaws close onto the stand. Once snug but not tight, push the tab down (do not force) until it locks into place. If it cannot be locked without placing too much pressure, turn the tab counter-clockwise to loosen a bit until the tab can be pressed down and locked. Too much pressure to lock the tab could break it. The cup holder should now fit snugly on the stand.

**NOTE:** On music stands that have a diameter of 1" or more, you may have to take the nut off instead of just loosening the clamp. Clamp should accommodate up to 1-1/4" diameter.

Figure 5.

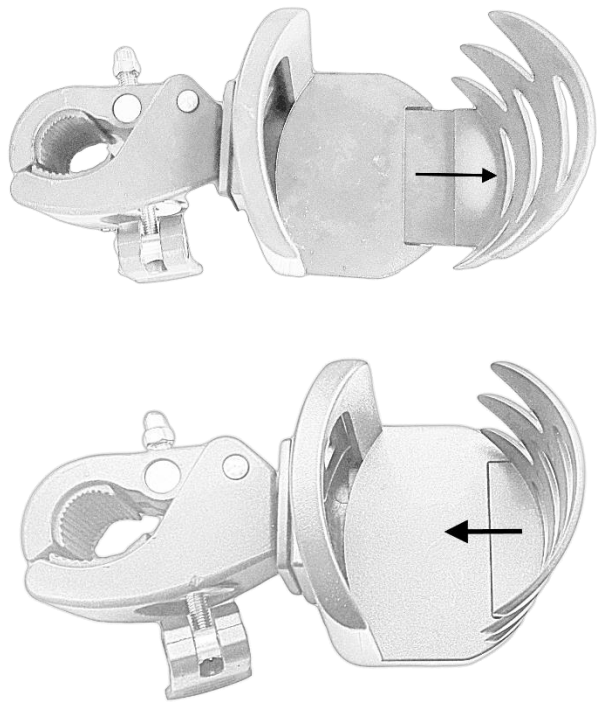

## **CRESCENDO® MUSIC GEAR**

500 Westover Dr. #3772

Sanford, NC 27330

[www.crescendomusicgear.com](http://www.crescendomusicgear.com)

[support@crescendomusicgear.com](mailto:support@crescendomusicgear.com)

5. Figure 5 shows the extension and contraction of the cup holder to accommodate various size drinks. Simply pull out in order to place larger bottles or cans in the holder. To size the cup holder for the drink, it is recommended to pull the extension all the way out, place the drink in the holder, and push the extension in for a snug fit. The drink can then be removed and replaced easily.

